

MAIN LEVEL
633 SQ.FT

315 Park Street W, Dundas L9H 1Z1

TOTAL APPROX. FLOOR AREA 633 SQ.FT

Whilst every attempt has been made to ensure the accuracy of the floor plan contained here, measurements of doors, windows, rooms and any other items are approximate and no responsibility is taken for any error, omission, or misstatement. This plan is for illustrative purposes only and should be used as such by any prospective purchaser.

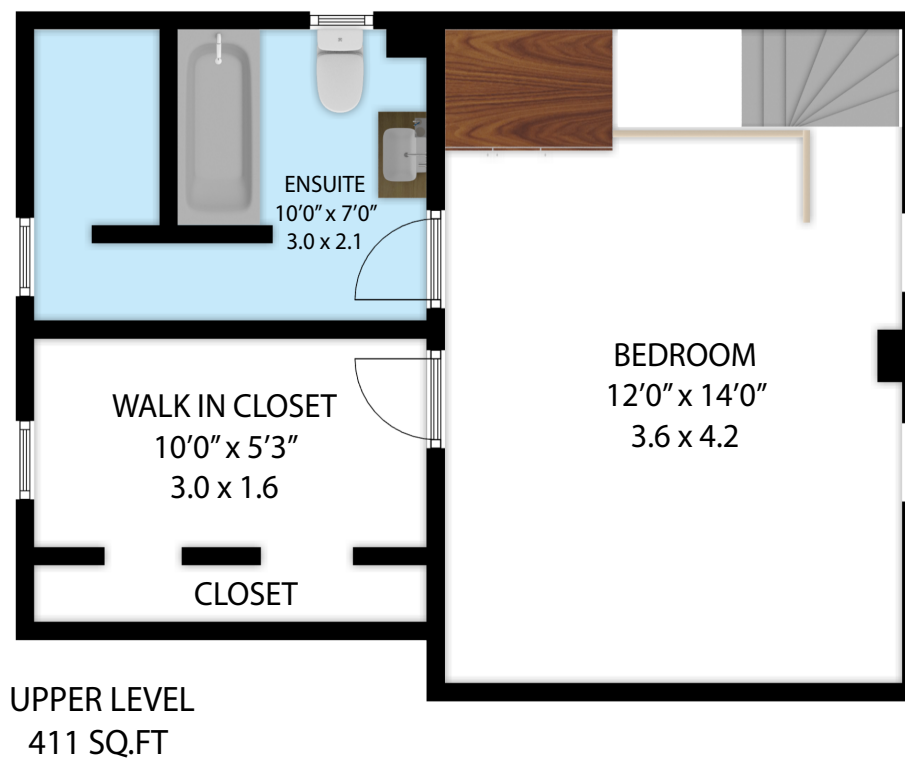

315 Park Street W, Dundas L9H 1Z1

TOTAL APPROX. FLOOR AREA 411 SQ.FT

Whilst every attempt has been made to ensure the accuracy of the floor plan contained here, measurements of doors, windows, rooms and any other items are approximate and no responsibility is taken for any error, omission, or misstatement. This plan is for illustrative purposes only and should be used as such by any prospective purchaser.

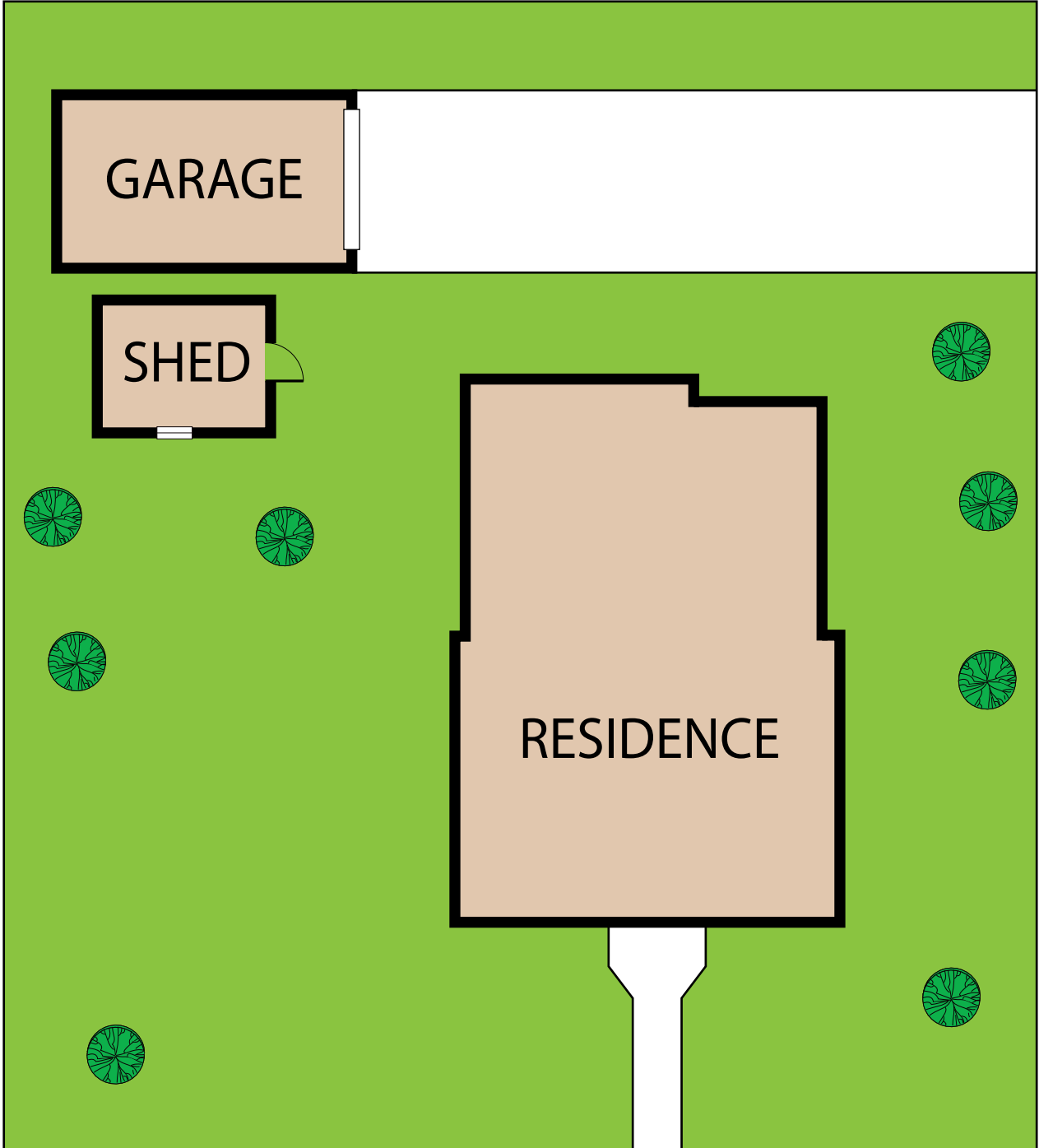

315 Park Street W, Dundas L9H 1Z1

Whilst every attempt has been made to ensure the accuracy of the floor plan contained here, measurements of doors, windows, rooms and any other items are approximate and no responsibility is taken for any error, omission, or misstatement. This plan is for illustrative purposes only and should be used as such by any prospective purchaser.



ADDRESS: 315 Park Street W, Dundas L9H 1Z1

Main Level

Room Description	Imperial	Metric
Living	12'2" x 13'10"	3.7 x 4.2
Office	10'0" x 13'0"	3.0 x 3.9
Kitchen	13'3" x 13'6"	4.0 x 4.1

Upper Level

Room Description	Imperial	Totals
Bedroom	12'0" x 14'0"	3.6 x 4.2
Ensuite	10'0" x 7'0"	3.0 x 2.1
WIC	10'0" x 5'3"	3.0 x 1.6